



Educational Technology

File Maker Pro Menu Choice Fields

AS you are defining fields, decide which field may need to be a radio button, drop down or checklist.

Type name > create > options

- validation
- member of value list
- define value lists
- new
- type in our lists, be sure to separate by returns or comma
- click done

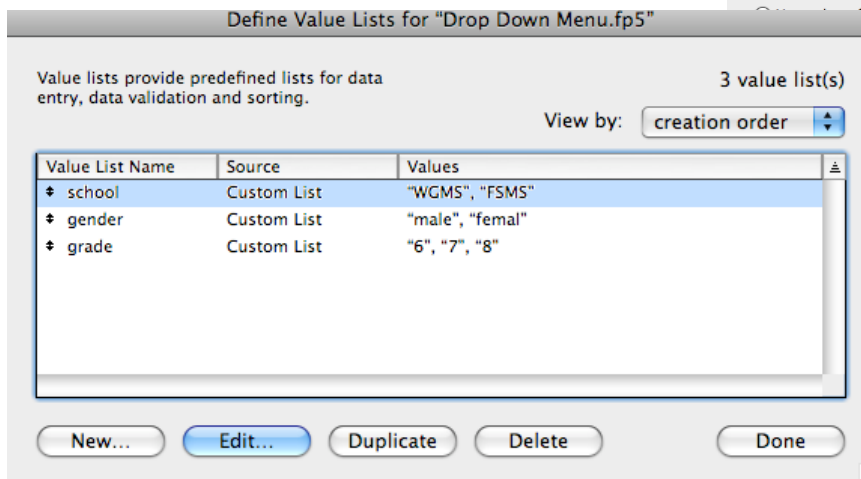
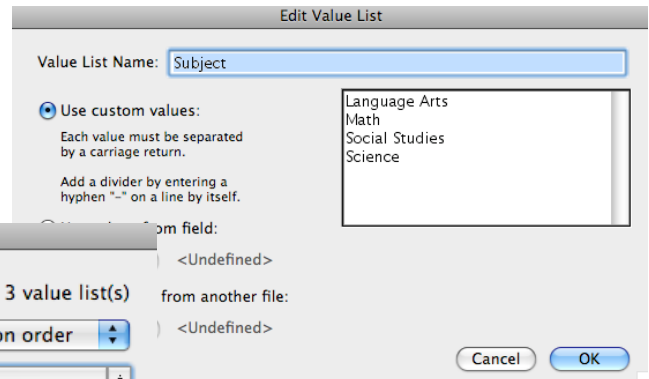
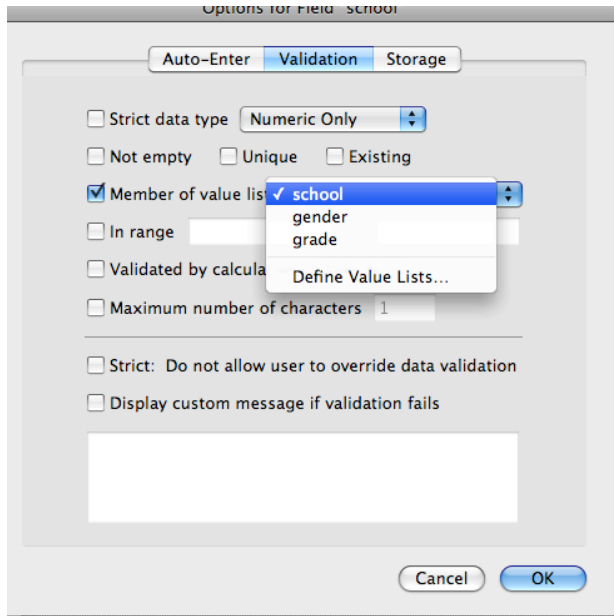

Next to Link you Value to your field.....

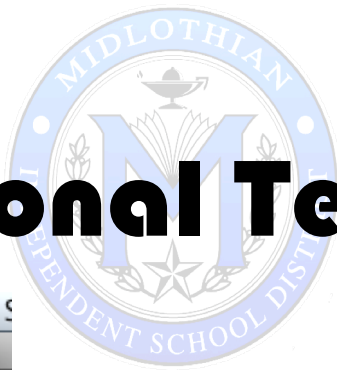

Educational Technology

File Maker Pro Menu Choice Fields

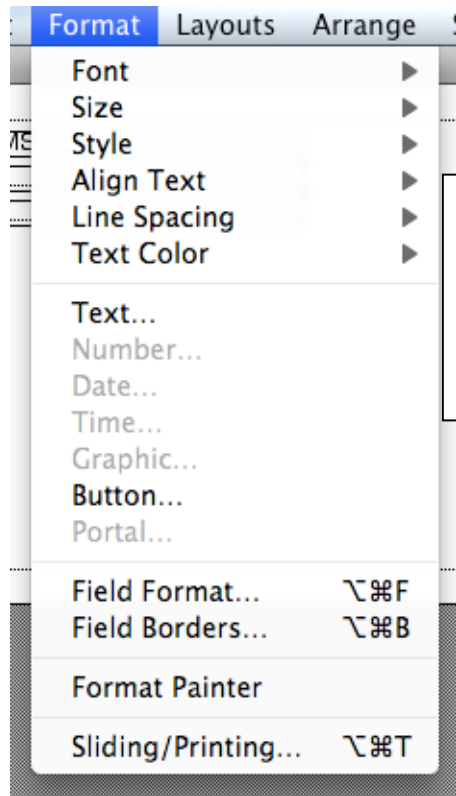

- >layout menu
- >select field
- >format
- >field format
- >pop-up

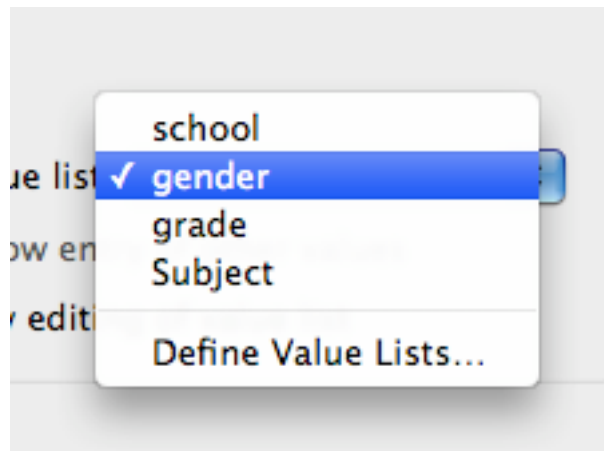
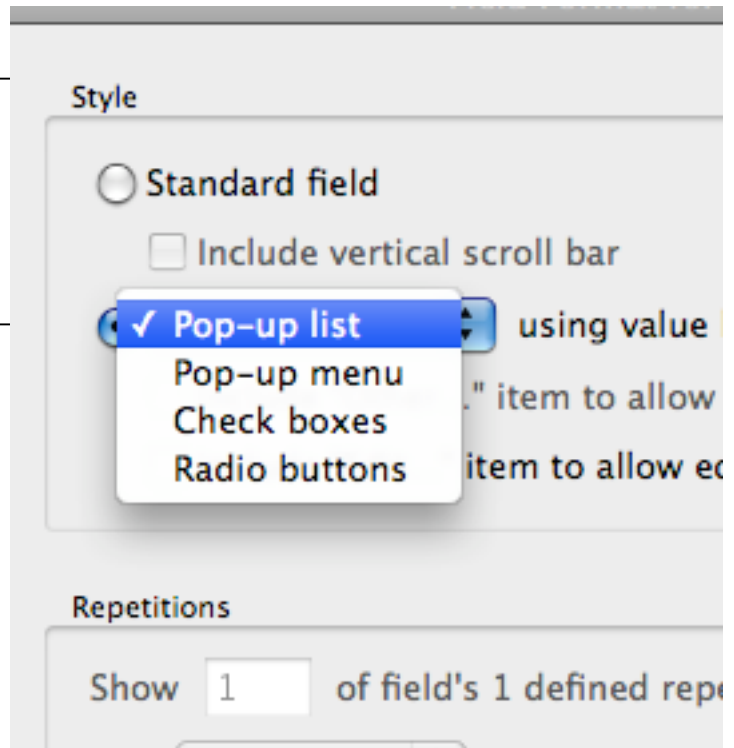

- >select value list to link to
- >select okay

In Browse Mode,
Test field to see if selections are as desired. If not,
edit options.

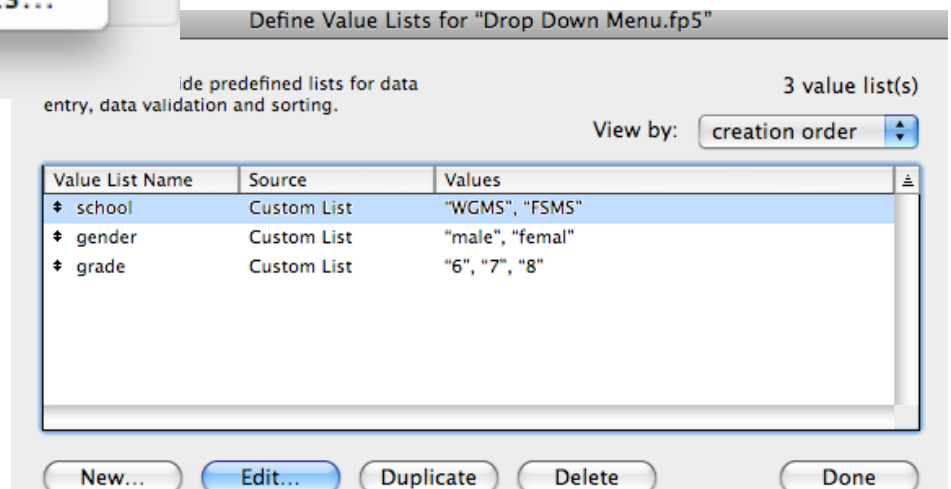

Use predefined lists for data entry, data validation and sorting.

3 value list(s)

View by: creation order

Value List Name	Source	Values
school	Custom List	"WGMS", "FSMS"
gender	Custom List	"male", "femal"
grade	Custom List	"6", "7", "8"

New... Edit... Duplicate Delete Done